

- Legend:**
- City Boundary
 - Proposed Development Boundary
 - Proposed Road Geometry
 - Earthworks - Fill
 - Earthworks - Cut
 - Proposed Carriageway Pavement
 - Proposed Grass Verge
 - Proposed Cycleway
 - Proposed Footpath
 - Proposed Shared Footpath/Cycleway
 - Proposed Traffic Island
 - Structure (S)
 - Proposed Retaining wall (R)
 - Proposed Mammal Underpass (C)
 - Proposed Culvert (C)
 - Proposed Attenuation Pond / Infiltration Basin / Wetlands
 - Proposed Stream Diversion
 - AR - Access Road
 - WC - Watercourse

San áiríúmh tá sonraíocht Shuirbhíreachtú Orlánáís Éireann arna aistriúgeadh fíúí Cheadúnas OSI Uimh. 2010/20CCMA/Comhairle Contae na Gaillimhe. Sárúilíon aistriúgeadh neamhdáraithe cóipeacht Shuirbhíreachtú Orlánáís Éireann agus Rialtas na hÉireann. © Suirbhíreachtú Orlánáís Éireann, 2010.

© Suirbhíreachtú Orlánáís Éireann. Gach ceart ar chosaint. Uimhir cheadúnais 2010/20CCMA/Comhairle Contae na Gaillimhe.

Includes Ordnance Survey Ireland data reproduced under OSI Licence number 2010/20CCMA/Galway County Council. Unauthorised reproduction infringes Ordnance Survey Ireland and Government of Ireland copyright. © Ordnance Survey Ireland, 2010.

© Ordnance Survey Ireland. All rights reserved. Licence number 2010/20CCMA/Galway County Council.

Clients

An Roinn Iompair Turasoireachta agus Spóirt
Department Transport, Tourism and Sport

Project Ireland 2040
The National Development Plan

Comhairle Chontae na Gaillimhe
Galway County Council

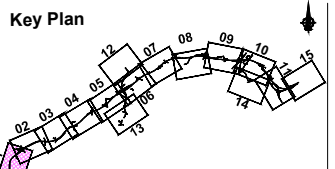

Consultant

ARUP

Corporate House
City East Business Park
Ballybrat, Galway, Ireland.

Tel +353 (0)91 460675
www.N6GalwayCity.ie
www.arup.ie

Job Title
N6 Galway City Ring Road

Scale
1:5000 @ A3

Date:
September 2018

Issue	Date	By	Chkd	Appd
I2	17/02/2020	KJ	HK	EMC
I1	28/09/2018	KJ	MH	EMC

Drawing Title
Proposed Road Development Plan
CH.0+000 to CH.1+350
Sheet 1 of 15

Drawing Status
For Information

Job No
233985

Drawing No
Figure 5.1.01

Issue
I2

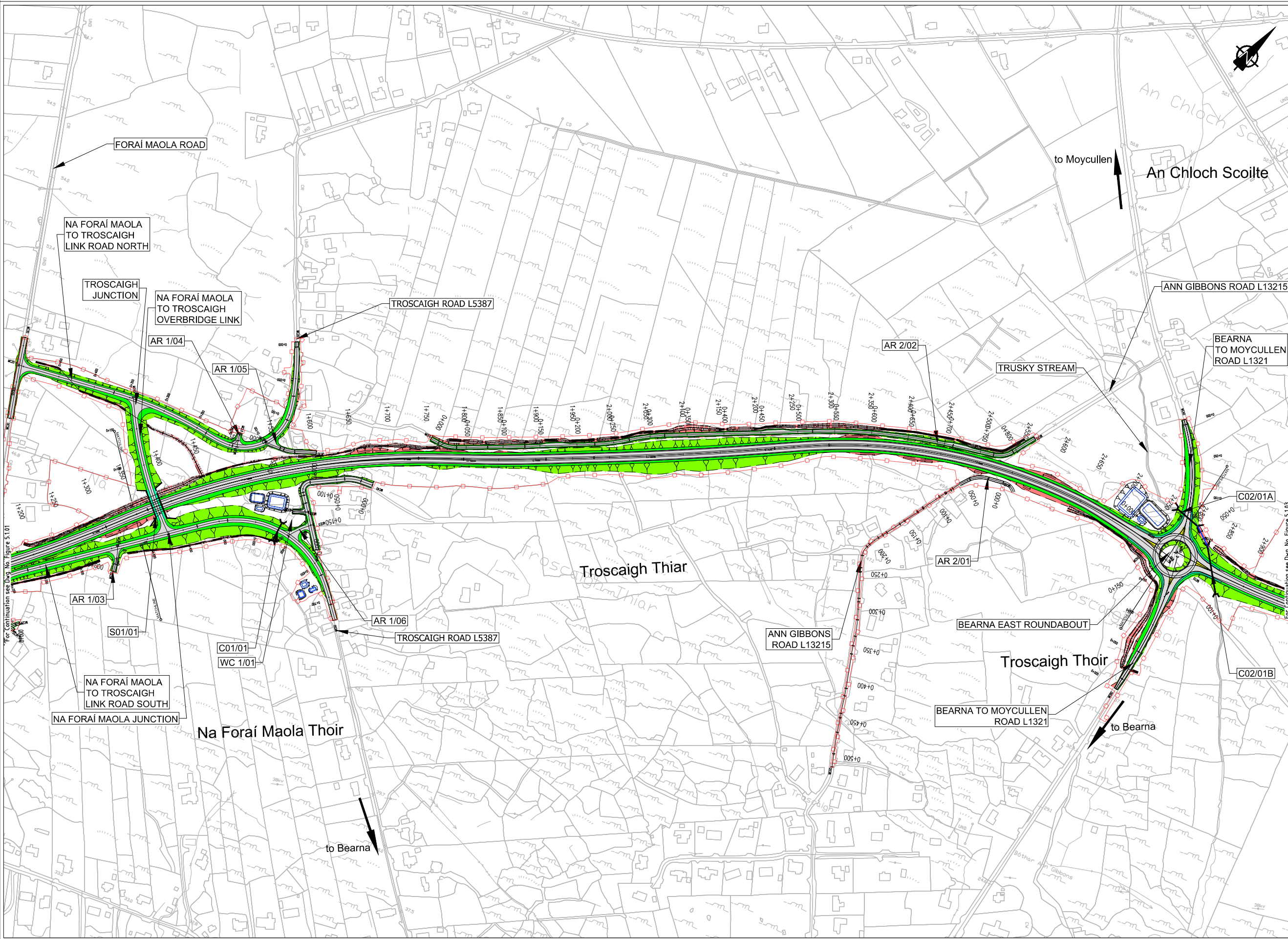

- Legend:**
- City Boundary
 - Proposed Development Boundary
 - Proposed Road Geometry
 - Earthworks - Fill
 - Earthworks - Cut
 - Proposed Carriageway Pavement
 - Proposed Grass Verge
 - Proposed Cycleway
 - Proposed Footpath
 - Proposed Shared Footpath/Cycleway
 - Proposed Traffic Island
 - Structure (S)
 - Proposed Retaining wall (R)
 - Proposed Mammal Underpass (C)
 - Proposed Culvert (C)
 - Proposed Attenuation Pond / Infiltration Basin / Wetlands
 - Proposed Stream Diversion
 - AR AR - Access Road
 - WC WC - Watercourse

Son áireamh tá sonraíocht Shairbhíreacht Orlándaí Éireann arna aistriú go dtí físeán OSI Uimh. 2010/20CCMA/Comhairle Contae na Gaillimhe. Sáráilonn aistriú go dtí físeán na h-áireamh seo Shairbhíreacht Orlándaí Éireann agus Rialtas na hÉireann. © Shairbhíreacht Orlándaí Éireann, 2010.

© Sairbhíreacht Orlándaí Éireann. Gach ceart ar chosaint. Uimhir cheadainis 2010/20CCMA/Comhairle Contae na Gaillimhe.

Includes Ordnance Survey Ireland data reproduced under OSI Licence number 2010/20CCMA/Galway County Council. Unauthorised reproduction infringes Ordnance Survey Ireland and Government of Ireland copyright. © Ordnance Survey Ireland, 2010.

© Ordnance Survey Ireland. All rights reserved. Licence number 2010/20CCMA/Galway County Council.

Clients

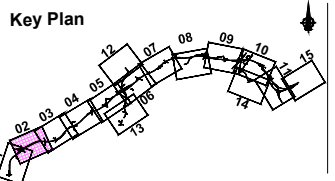

Consultant

Corporate House
City East Business Park
Ballybrit, Galway, Ireland.

Tel +353 (0)91 460675
www.N6GalwayCity.ie
www.arup.ie

Job Title
N6 Galway City Ring Road

Scale
1:5000 @ A3

Date:
September 2018

Issue	Date	By	Chkd	Appd
I2	17/02/2020	KJ	HK	EMC
I1	28/09/2018	KJ	MH	EMC

Drawing Title
Proposed Road Development Plan
CH.1+350 to CH.2+799
Sheet 2 of 15

Drawing Status
For Information

Job No
233985

Drawing No
Figure 5.1.02

Issue
12

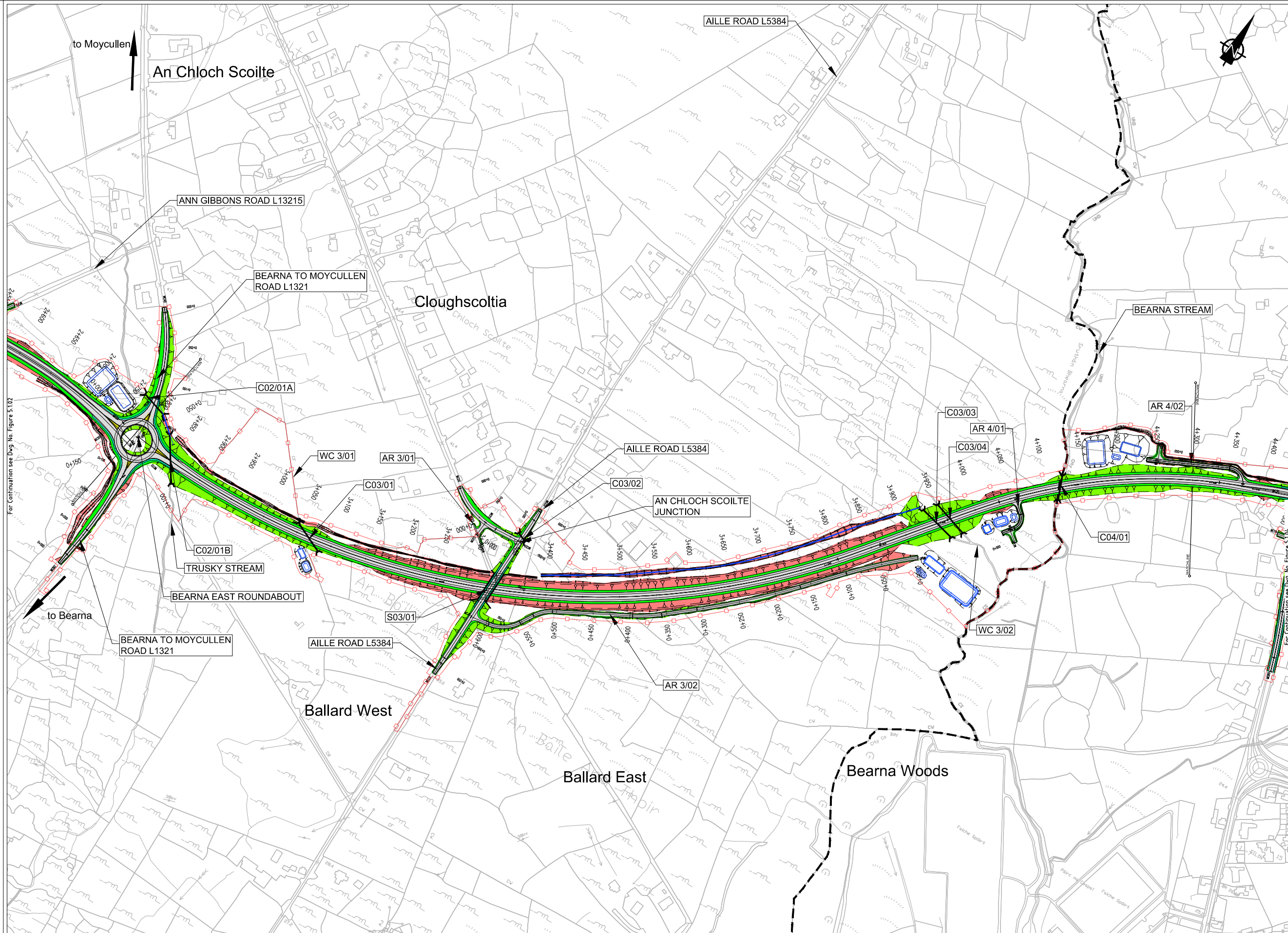

- Legend:**
- City Boundary
 - - - Proposed Development Boundary
 - ▬▬▬ Proposed Road Geometry
 - ▬▬▬ Earthworks - Fill
 - ▬▬▬ Earthworks - Cut
 - ▬▬▬ Proposed Carriageway Pavement
 - ▬▬▬ Proposed Grass Verge
 - ▬▬▬ Proposed Cycleway
 - ▬▬▬ Proposed Footpath
 - ▬▬▬ Proposed Shared Footpath/Cycleway
 - ▬▬▬ Proposed Traffic Island
 - ▬▬▬ Structure (S)
 - ▬▬▬ Proposed Retaining wall (R)
 - ▬▬▬ Proposed Mammal Underpass (C)
 - ▬▬▬ Proposed Culvert (C)
 - ▬▬▬ Proposed Attenuation Pond / Infiltration Basin / Wetlands
 - ▬▬▬ Proposed Stream Diversion
 - AR AR - Access Road
 - WC WC - Watercourse

For Continuation see Dwg No. Figure 5.1.02

For Continuation see Dwg No. Figure 5.1.03

Son áiríamh tá sonraíocht Shairbhíreacht Orlándaí Éireann arna aistriú go dtí físeán OSI Uimh. 2010/20CCMA/Comhairle Contae na Gaillimhe. Sáráilíon aistriú go dtí na h-áiríamh na cíoscheart Shairbhíreacht Orlándaí Éireann agus Rialtas na hÉireann. © Sairbhíreacht Orlándaí Éireann, 2010.

© Sairbhíreacht Orlándaí Éireann. Gach ceart ar chosaint. Uimhir cheadainis 2010/20CCMA/Comhairle Contae na Gaillimhe.

Includes Ordnance Survey Ireland data reproduced under OSI Licence number 2010/20CCMA/Galway County Council. Unauthorised reproduction infringes Ordnance Survey Ireland and Government of Ireland copyright. © Ordnance Survey Ireland, 2010.

© Ordnance Survey Ireland. All rights reserved. Licence number 2010/20CCMA/Galway County Council.

Clients

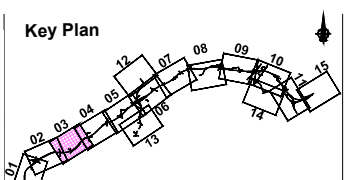

Consultant

Corporate House
City East Business Park
Ballybrit, Galway, Ireland.

Tel +353 (0)91 460675
www.N6GalwayCity.ie
www.arup.ie

Job Title
N6 Galway City Ring Road

Scale
1:5000 @ A3

Date:
September 2018

Issue	Date	By	Chkd	Appd
I2	17/02/2020	KJ	HK	EMC
I1	28/09/2018	KJ	MH	EMC

Drawing Title
Proposed Road Development Plan
CH.2+799 to CH.4+300
Sheet 3 of 15

Drawing Status
For Information

Job No
233985

Drawing No
Figure 5.1.03

Issue
12

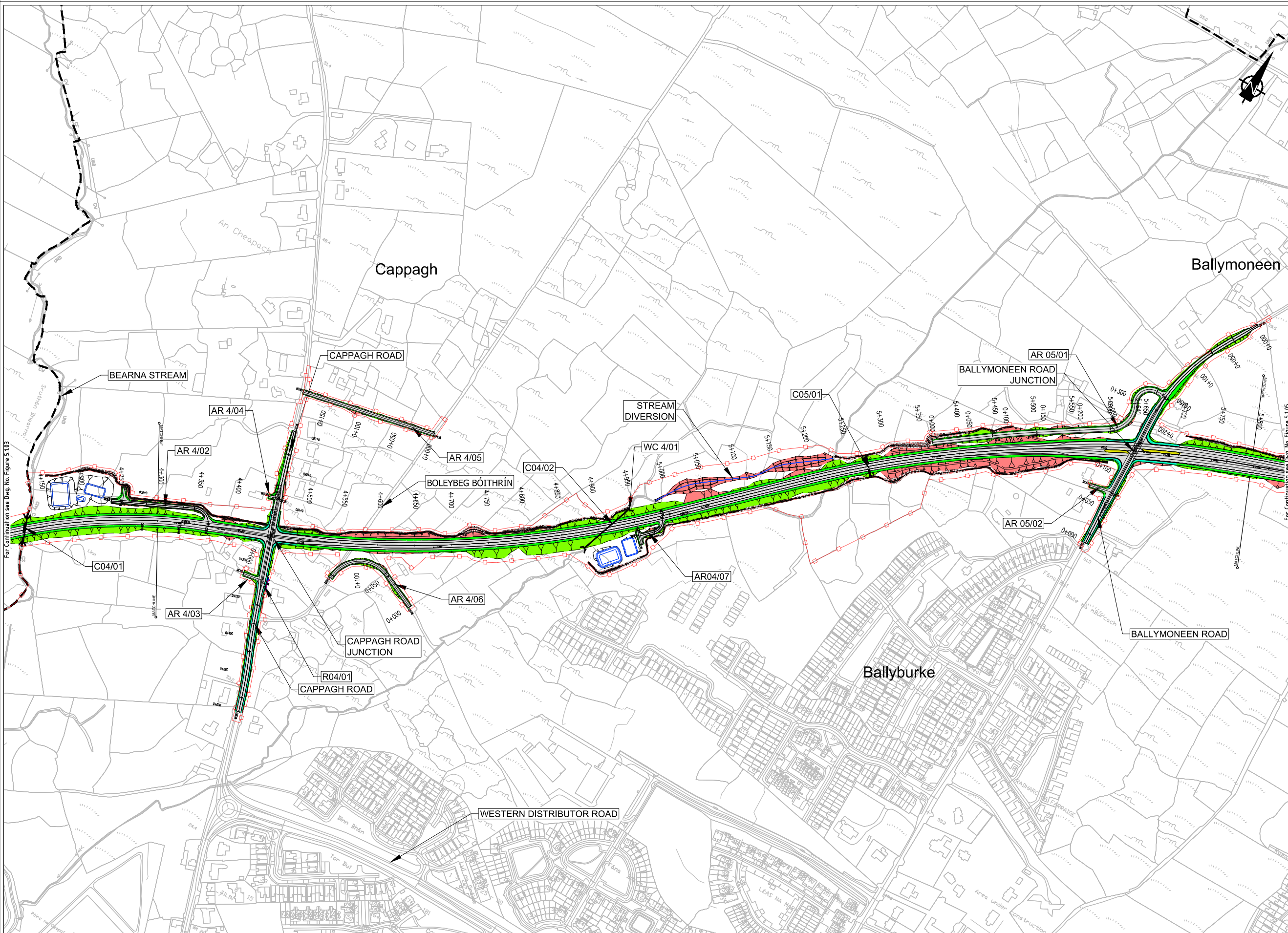

- Legend:**
- City Boundary
 - - - Proposed Development Boundary
 - ▬▬▬ Proposed Road Geometry
 - ▬▬▬ Earthworks - Fill
 - ▬▬▬ Earthworks - Cut
 - ▬▬▬ Proposed Carriageway Pavement
 - ▬▬▬ Proposed Grass Verge
 - ▬▬▬ Proposed Cycleway
 - ▬▬▬ Proposed Footpath
 - ▬▬▬ Proposed Shared Footpath/Cycleway
 - ▬▬▬ Proposed Traffic Island
 - ▬▬▬ Structure (S)
 - ▬▬▬ Proposed Retaining wall (R)
 - ▬▬▬ Proposed Mammal Underpass (C)
 - ▬▬▬ Proposed Culvert (C)
 - ▬▬▬ Proposed Attenuation Pond / Infiltration Basin / Wetlands
 - ▬▬▬ Proposed Stream Diversion
 - AR AR - Access Road
 - WC WC - Watercourse

For Continuation see Fig. No. Figure 5.103

For Continuation see Fig. No. Figure 5.105

Son áiríonn sé na sonraíochtaí Shairbhíreacht Orlándaí Éireann arna aistriú go dtí físeán Ceardúnas OSI Uimh. 2010/20CCMA/Comhairle Contae na Gaillimhe. Sáráilonn aistriú go dtí neamháidaráithe cóipeacht Shairbhíreacht Orlándaí Éireann agus Rialtas na hÉireann. © Sairbhíreacht Orlándaí Éireann, 2010.

© Sairbhíreacht Orlándaí Éireann. Gach ceart ar chosaint.
Uimhir cheadúnais 2010/20CCMA/Comhairle Contae na Gaillimhe.

Includes Ordnance Survey Ireland data reproduced under OSI Licence number 2010/20CCMA/Galway County Council.
Unauthorised reproduction infringes Ordnance Survey Ireland and Government of Ireland copyright. © Ordnance Survey Ireland, 2010.

© Ordnance Survey Ireland. All rights reserved. Licence number 2010/20CCMA/Galway County Council.

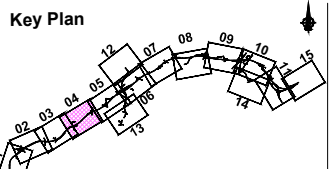

Job Title
N6 Galway City Ring Road

Scale
1:5000 @ A3

Date:
September 2018

Issue	Date	By	Chkd	Appd
I2	17/02/2020	KJ	HK	EMC
I1	28/09/2018	KJ	MH	EMC

Drawing Title
**Proposed Road Development Plan
CH.4+300 to CH.5+800
Sheet 4 of 15**

Drawing Status
For Information

Job No
233985

Drawing No
Figure 5.1.04

Issue
I2

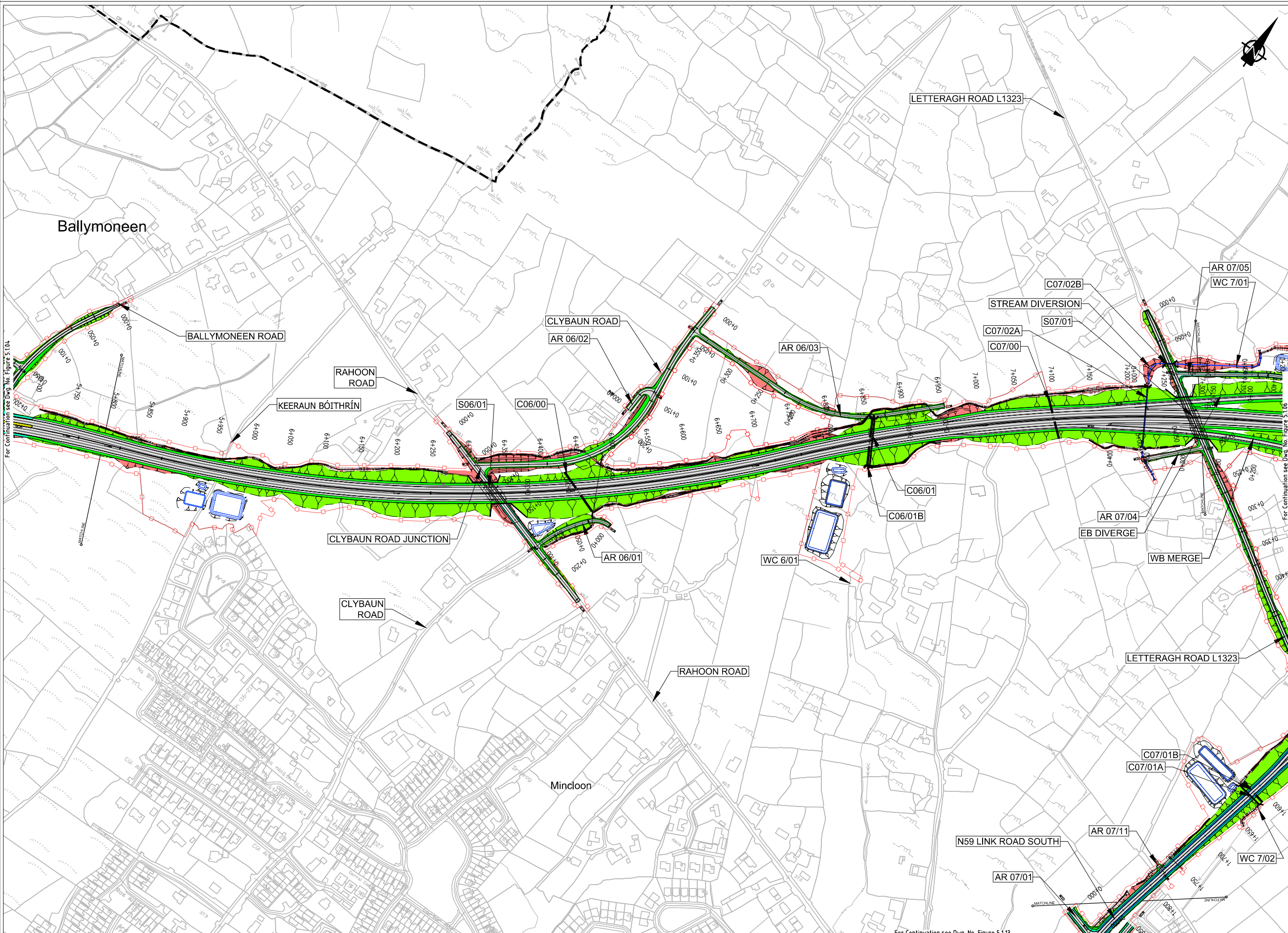

- Legend:**
- City Boundary
 - Proposed Development Boundary
 - Proposed Road Geometry
 - Earthworks - Fill
 - Earthworks - Cut
 - Proposed Carriageway Pavement
 - Proposed Grass Verge
 - Proposed Cycleway
 - Proposed Footpath
 - Proposed Shared Footpath/Cycleway
 - Proposed Traffic Island
 - Structure (S)
 - Proposed Retaining wall (R)
 - Proposed Mammal Underpass (C)
 - Proposed Culvert (C)
 - Proposed Attenuation Pond / Infiltration Basin / Wetlands
 - Proposed Stream Diversion
 - AR - Access Road
 - WC - Watercourse

Sun áiríonn tá sonraíocht Shairbhéiríochta Ordnáis Éireann arna aistriú go dtailíú físeánúil OSI Uimh. 2010/20CCMA/Comhairle Contae na Gaillimhe. Sáráilíonn aistriú go dtailíú na cíoscheart Shairbhéiríochta Ordnáis Éireann agus Rialtas na hÉireann. © Sairbhéiríochta Ordnáis Éireann, 2010.

© Sairbhéiríochta Ordnáis Éireann. Gach ceart ar chosaint. Uimhir cheadnáis 2010/20CCMA/Comhairle Contae na Gaillimhe.

Includes Ordnance Survey Ireland data reproduced under OSI Licence number 2010/20CCMA/Galway County Council. Unauthorised reproduction infringes Ordnance Survey Ireland and Government of Ireland copyright. © Ordnance Survey Ireland, 2010.

© Ordnance Survey Ireland. All rights reserved. Licence number 2010/20CCMA/Galway County Council.

Clients

Comhairle Chontae na Gaillimhe Galway County Council

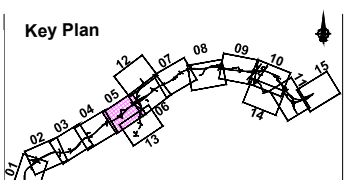

Consultant

Corporate House
City East Business Park
Ballybrit, Galway, Ireland.

Tel +353 (0)91 460675
www.N6GalwayCity.ie
www.arup.ie

Job Title
N6 Galway City Ring Road

Scale
1:5000 @ A3

Date
September 2018

Issue	Date	By	Chkd	Appd
I2	17/02/2020	KJ	HK	EMC
I1	28/09/2018	KJ	MH	EMC

Drawing Title
Proposed Road Development Plan
CH.5+800 to CH.7+300
Sheet 5 of 15

Drawing Status
For Information

Job No
233985

Drawing No
Figure 5.1.05

Issue
I2

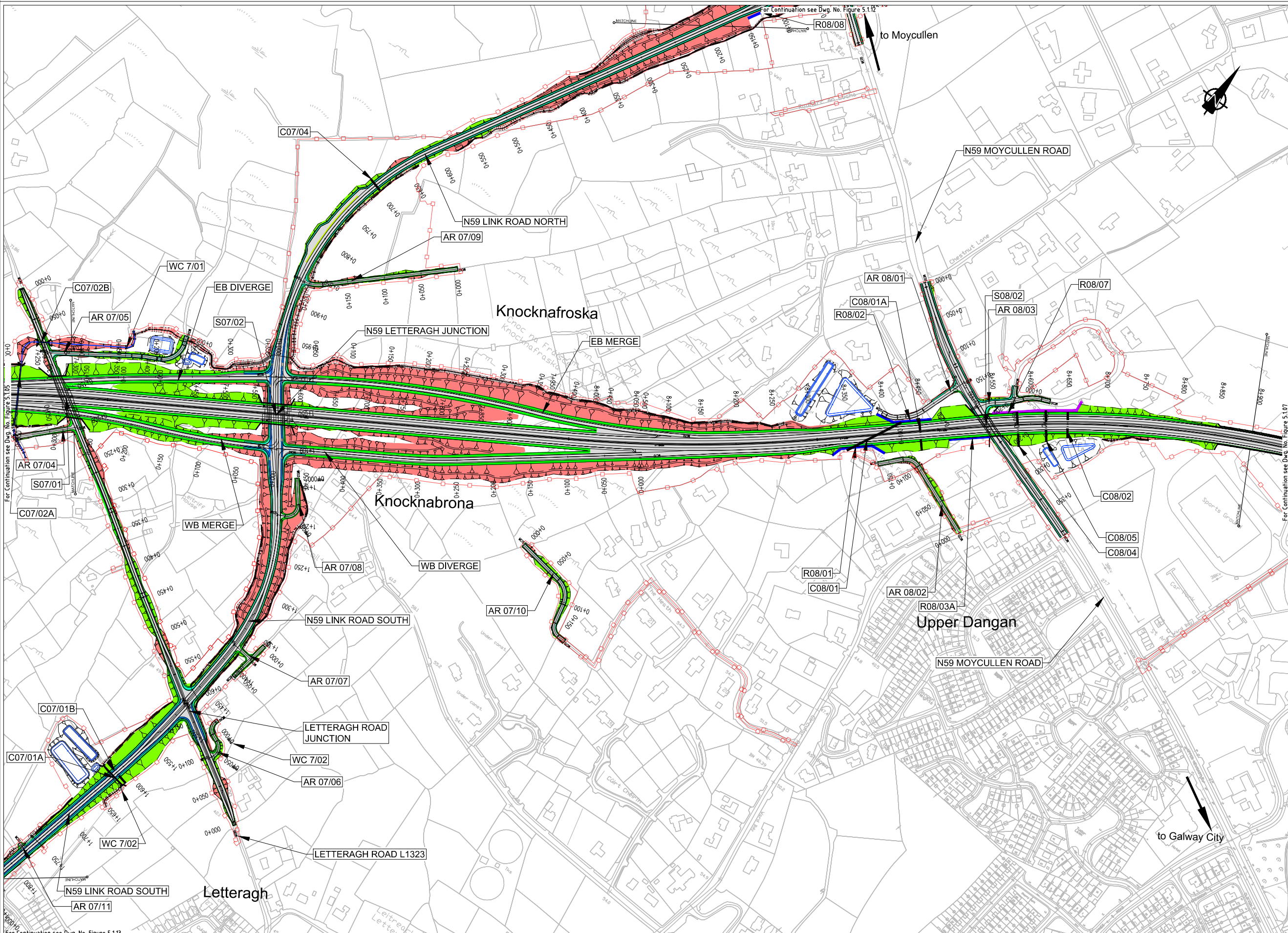

- Legend:**
- City Boundary
 - - - Proposed Development Boundary
 - ▬▬▬ Proposed Road Geometry
 - ▬▬▬ Earthworks - Fill
 - ▬▬▬ Earthworks - Cut
 - ▬▬▬ Proposed Carriageway Pavement
 - ▬▬▬ Proposed Grass Verges
 - ▬▬▬ Proposed Cycleway
 - ▬▬▬ Proposed Footpath
 - ▬▬▬ Proposed Shared Footpath/Cycleway
 - ▬▬▬ Proposed Traffic Island
 - ▬▬▬ Structure (S)
 - ▬▬▬ Proposed Retaining wall (R)
 - ▬▬▬ Proposed Mammal Underpass (C)
 - ▬▬▬ Proposed Culvert (C)
 - ▬▬▬ Proposed Attenuation Pond / Infiltration Basin / Wetlands
 - ▬▬▬ Proposed Stream Diversion
 - AR - Access Road
 - WC - Watercourse

San áiríúmh tá sonraíocht Shairbhéireacht Orlándaí Éireann arna aistriú go dtailíocht físe Chéadainn OSI Uimh. 2010/20CCMA/Comhairle Contae na Gaillimhe. Sáráilíon aistriú go dtailíocht neamháidaráithe cóipeacht Shairbhéireacht Orlándaí Éireann agus Rialtas na hÉireann. © Sairbhéireacht Orlándaí Éireann, 2010.

© Sairbhéireacht Orlándaí Éireann. Gach ceart ar chosaint. Uimhir cheadainn 2010/20CCMA/Comhairle Contae na Gaillimhe.

Includes Ordnance Survey Ireland data reproduced under OSI Licence number 2010/20CCMA/Galway County Council. Unauthorised reproduction infringes Ordnance Survey Ireland and Government of Ireland copyright. © Ordnance Survey Ireland, 2010.

© Ordnance Survey Ireland. All rights reserved. Licence number 2010/20CCMA/Galway County Council.

Clients

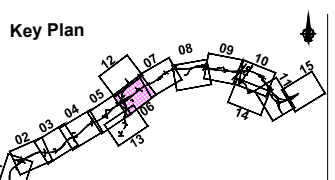

Consultant

Corporate House
City East Business Park
Ballybrit, Galway, Ireland.

Tel +353 (0)91 460675
www.N6GalwayCity.ie
www.arup.ie

Job Title
N6 Galway City Ring Road

Scale
1:5000 @ A3

Date
September 2018

Issue	Date	By	Chkd	Appd
I2	17/02/2020	KJ	HK	EMC
I1	28/09/2018	KJ	MH	EMC

Drawing Title
**Proposed Road Development Plan
CH.7+300 to CH.8+900
Sheet 6 of 15**

Drawing Status
For Information

Job No
233985

Drawing No
Figure 5.1.06

Issue
12

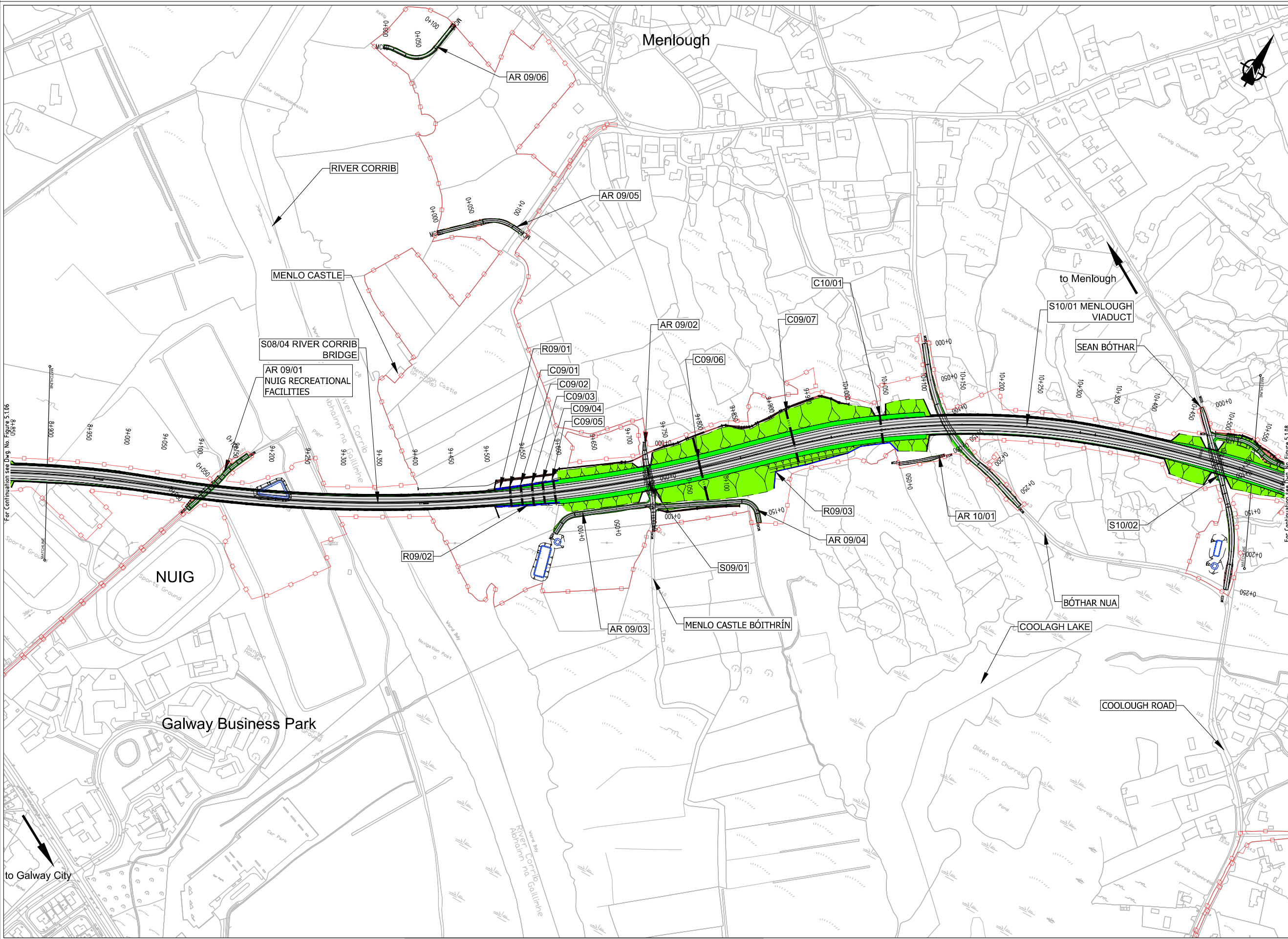

- Legend:**
- City Boundary
 - Proposed Development Boundary
 - Proposed Road Geometry
 - Earthworks - Fill
 - Earthworks - Cut
 - Proposed Carriageway Pavement
 - Proposed Grass Verge
 - Proposed Cycleway
 - Proposed Footpath
 - Proposed Shared Footpath/Cycleway
 - Proposed Traffic Island
 - Structure (S)
 - Proposed Retaining wall (R)
 - Proposed Mammal Underpass (C)
 - Proposed Culvert (C)
 - Proposed Attenuation Pond / Infiltration Basin / Wetlands
 - Proposed Stream Diversion
 - AR - Access Road
 - WC - Watercourse

For Continuation see Dwg. No. Figure 5.1.06

For Continuation see Dwg. No. Figure 5.1.08

Son áiríamh tá sonraíocht Shairbhéireacht Ordnáis Éireann arna aistriú go dtí fíor Cheadúnas OSI Uimh. 2010/20CCMA/Comhairle Contae na Gaillimhe. Sárú ar na sonraíocht na mbhídaraithe cóipeacht Shairbhéireacht Ordnáis Éireann agus Rialtas na hÉireann. © Sairbhéireacht Ordnáis Éireann, 2010.

Includes Ordnance Survey Ireland data reproduced under OSI Licence number 2010/20CCMA/Galway County Council. Unauthorised reproduction infringes Ordnance Survey Ireland and Government of Ireland copyright. © Ordnance Survey Ireland, 2010.

Clients

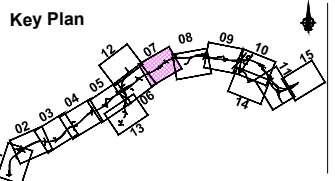

Consultant

Corporate House
City East Business Park
Ballybrit, Galway, Ireland.

Tel +353 (0)91 460675
www.N6GalwayCity.ie
www.arup.ie

Job Title
N6 Galway City Ring Road

Scale
1:5000 @ A3

Date
September 2018

Issue	Date	By	Chkd	Appd
I2	17/02/2020	KJ	HK	EMC
I1	28/09/2018	KJ	MH	EMC

Drawing Title
Proposed Road Development Plan
CH.8+900 to CH.10+550
Sheet 7 of 15

Drawing Status
For Information

Job No
233985

Drawing No
Figure 5.1.07

Issue
I2

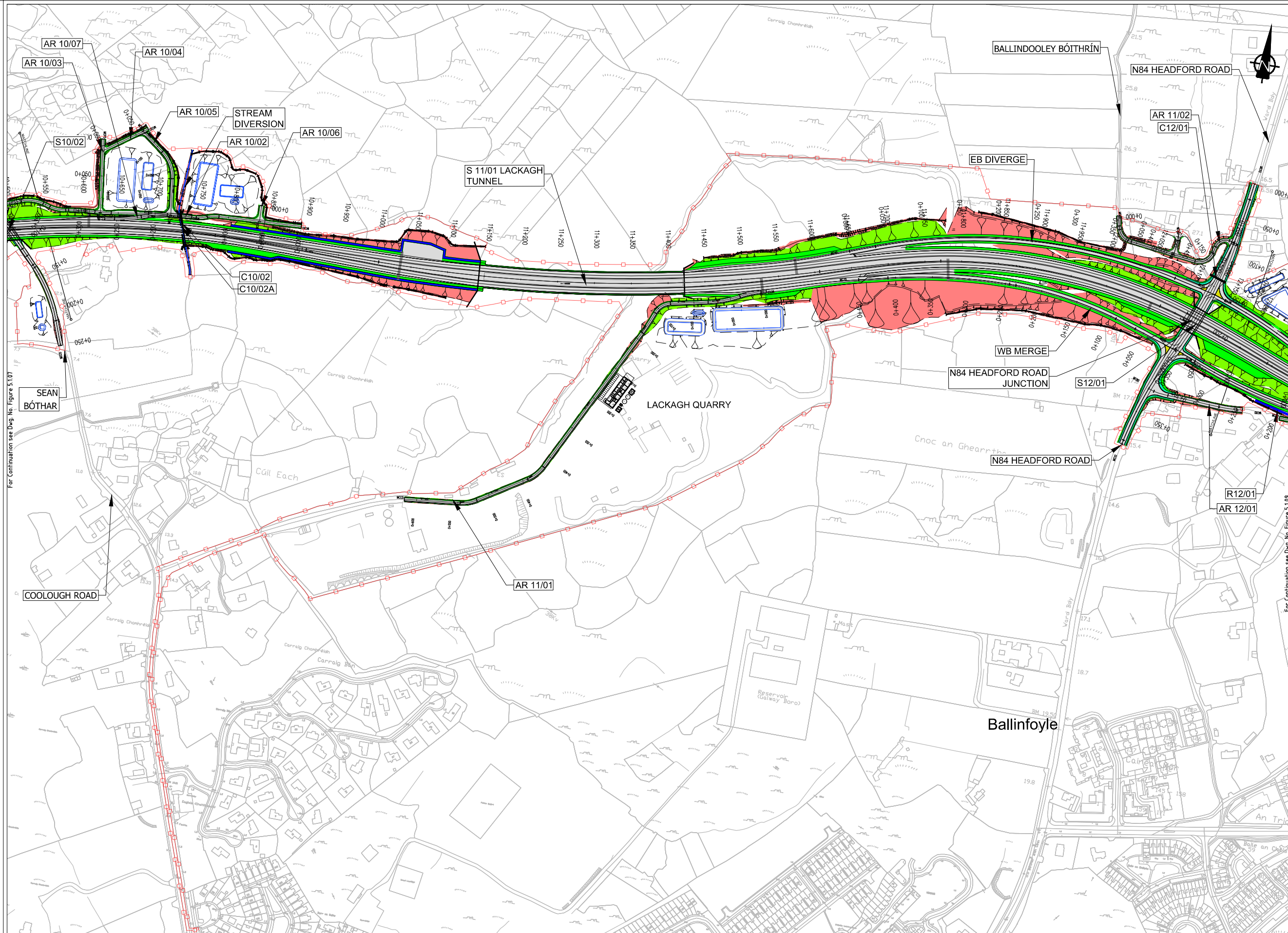

- Legend:**
- City Boundary
 - - - Proposed Development Boundary
 - ▬▬▬ Proposed Road Geometry
 - ▬▬▬ Earthworks - Fill
 - ▬▬▬ Earthworks - Cut
 - ▬▬▬ Proposed Carriageway Pavement
 - ▬▬▬ Proposed Grass Verge
 - ▬▬▬ Proposed Cycleway
 - ▬▬▬ Proposed Footpath
 - ▬▬▬ Proposed Shared Footpath/Cycleway
 - ▬▬▬ Proposed Traffic Island
 - ▬▬▬ Structure (S)
 - ▬▬▬ Proposed Retaining wall (R)
 - ▬▬▬ Proposed Mammal Underpass (C)
 - ▬▬▬ Proposed Culvert (C)
 - ▬▬▬ Proposed Attenuation Pond / Infiltration Basin / Wetlands
 - ▬▬▬ Proposed Stream Diversion
 - AR AR - Access Road
 - WC WC - Watercourse

For Continuation see Dwg. No. Figure 5.107

For Continuation see Dwg. No. Figure 5.109

Son áiríonn sé sonraíocht Shairbhíreacht Orlándaí Éireann arna aistriú go dtí físeán OSI Uimh. 2010/20CCMA/Comhairle Contae na Gaillimhe. Sáráilonn aistriú go dtí neamháidaráithe cóipeacht Shairbhíreacht Orlándaí Éireann agus Rialtas na hÉireann. © Sairbhíreacht Orlándaí Éireann, 2010.

© Sairbhíreacht Orlándaí Éireann. Gach ceart ar chosaint. Uimhir cheadainnis 2010/20CCMA/Comhairle Contae na Gaillimhe.

Includes Ordnance Survey Ireland data reproduced under OSI Licence number 2010/20CCMA/Galway County Council. Unauthorised reproduction infringes Ordnance Survey Ireland and Government of Ireland copyright. © Ordnance Survey Ireland, 2010.

© Ordnance Survey Ireland. All rights reserved. Licence number 2010/20CCMA/Galway County Council.

Clients

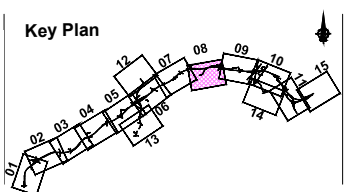

Consultant

Corporate House
City East Business Park
Ballybrit, Galway, Ireland.

Tel +353 (0)91 460675
www.N6GalwayCity.ie
www.arup.ie

Job Title
N6 Galway City Ring Road

Scale
1:5000 @ A3

Date:
September 2018

Issue	Date	By	Chkd	Appd
I2	17/02/2020	KJ	HK	EMC
I1	28/09/2018	KJ	MH	EMC

Drawing Title
**Proposed Road Development Plan
CH.10+550 to CH.12+200
Sheet 8 of 15**

Drawing Status
For Information

Job No
233985

Drawing No
Figure 5.1.08

Issue
I2

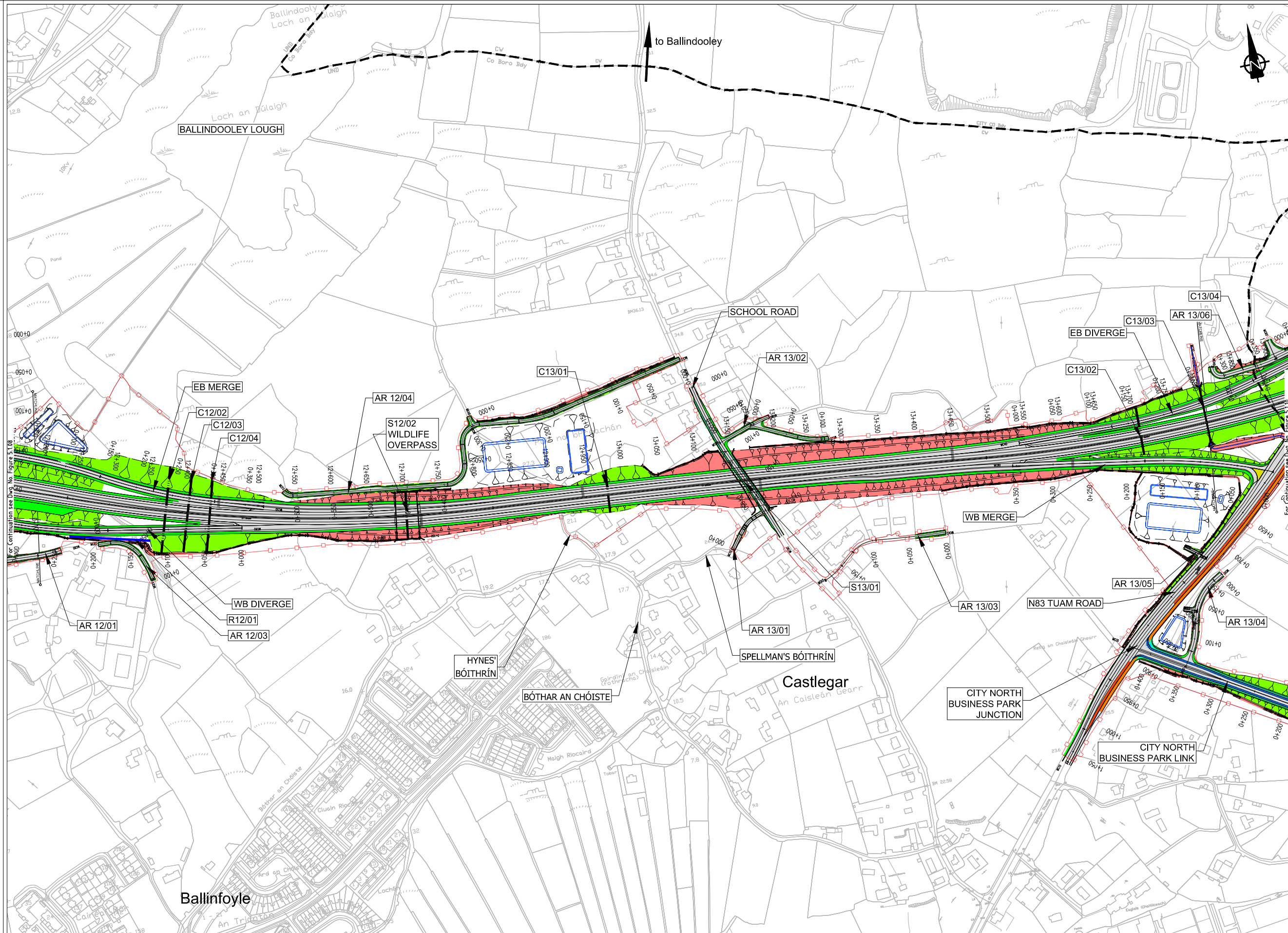

- Legend:**
- City Boundary
 - - - Proposed Development Boundary
 - ▬▬▬ Proposed Road Geometry
 - ▬▬▬ Earthworks - Fill
 - ▬▬▬ Earthworks - Cut
 - ▬▬▬ Proposed Carriageway Pavement
 - ▬▬▬ Proposed Grass Verge
 - ▬▬▬ Proposed Cycleway
 - ▬▬▬ Proposed Footpath
 - ▬▬▬ Proposed Shared Footpath/Cycleway
 - ▬▬▬ Proposed Traffic Island
 - ▬▬▬ Structure (S)
 - ▬▬▬ Proposed Retaining wall (R)
 - ▬▬▬ Proposed Mammal Underpass (C)
 - ▬▬▬ Proposed Culvert (C)
 - ▬▬▬ Proposed Attenuation Pond / Infiltration Basin / Wetlands
 - ▬▬▬ Proposed Stream Diversion
 - AR AR - Access Road
 - WC WC - Watercourse

Sun áiríomh tá sonraíocht Shairbhíreacht Orlándaí Éireann arna aistriú go dtailíocht físe Chreatúnas OSI Uimh. 2010/20CCMA/Comhairle Contae na Gaillimhe. Sáráilonn aistriú go dtailíocht na mbeatharthaíocht cíoscheart Shairbhíreacht Orlándaí Éireann agus Rialtas na hÉireann. © Sairbhíreacht Orlándaí Éireann, 2010.

© Sairbhíreacht Orlándaí Éireann. Gach ceart ar chosaint. Uimhir cheadúnais 2010/20CCMA/Comhairle Contae na Gaillimhe.

Includes Ordnance Survey Ireland data reproduced under OSI Licence number 2010/20CCMA/Galway County Council. Unauthorised reproduction infringes Ordnance Survey Ireland and Government of Ireland copyright. © Ordnance Survey Ireland, 2010.

© Ordnance Survey Ireland. All rights reserved. Licence number 2010/20CCMA/Galway County Council.

Clients

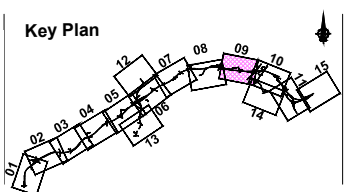

Consultant

Corporate House
City East Business Park
Ballybrit, Galway, Ireland.

Tel +353 (0)91 460675
www.N6GalwayCity.ie
www.arup.ie

Job Title
N6 Galway City Ring Road

Scale
1:5000 @ A3

Date:
September 2018

Issue	Date	By	Chkd	Appd
I2	17/02/2020	KJ	HK	EMC
I1	28/09/2018	KJ	MH	EMC

Drawing Title
Proposed Road Development Plan
CH.12+200 to CH.13+800
Sheet 9 of 15

Drawing Status
For Information

Job No
233985

Drawing No
Figure 5.1.09

Issue
12

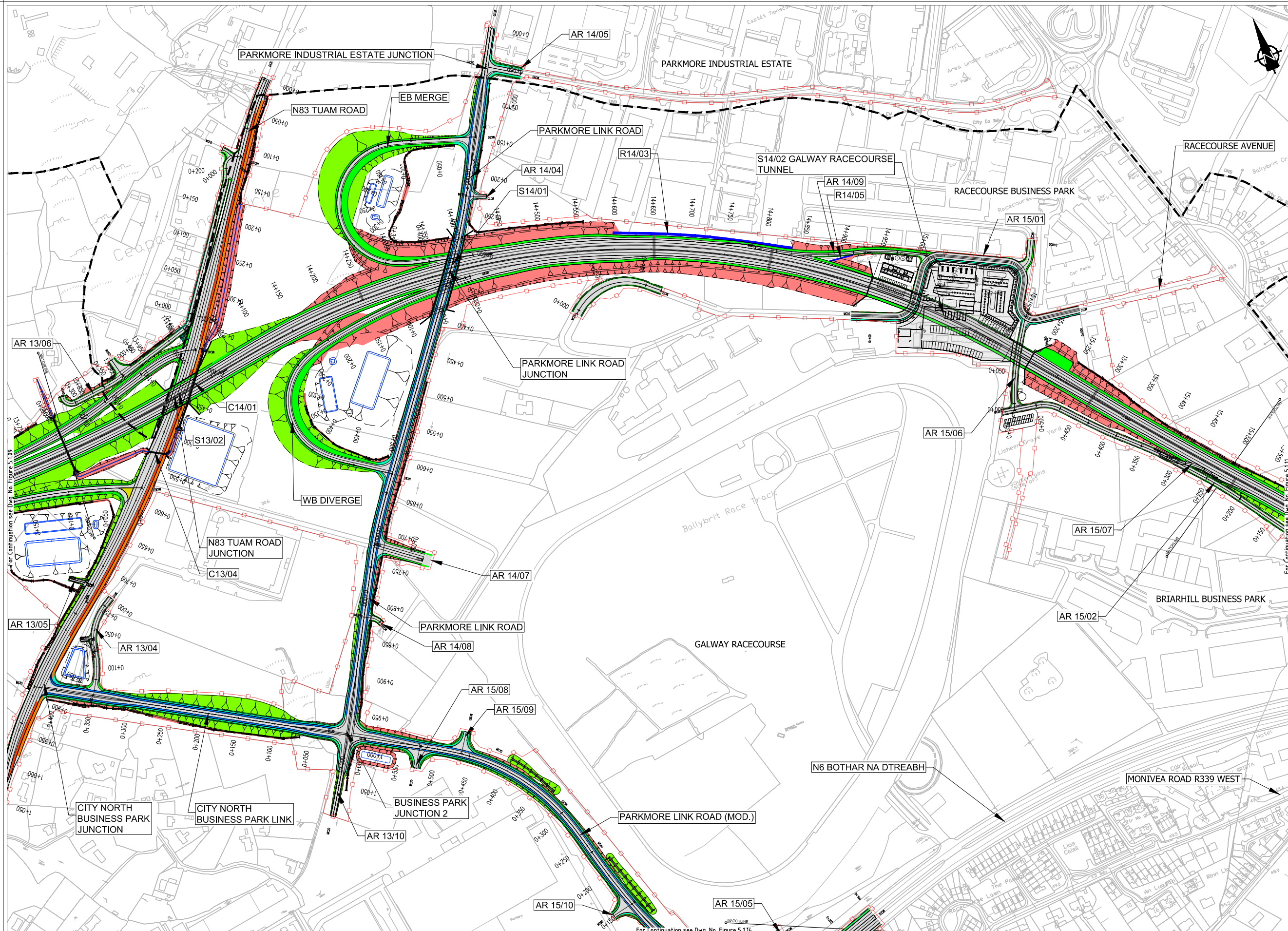

- Legend:**
- City Boundary
 - Proposed Development Boundary
 - Proposed Road Geometry
 - Earthworks - Fill
 - Earthworks - Cut
 - Proposed Carriageway Pavement
 - Proposed Grass Verge
 - Proposed Cycleway
 - Proposed Footpath
 - Proposed Shared Footpath/Cycleway
 - Proposed Traffic Island
 - Structure (S)
 - Proposed Retaining wall (R)
 - Proposed Mammal Underpass (C)
 - Proposed Culvert (C)
 - Proposed Attenuation Pond / Infiltration Basin / Wetlands
 - Proposed Stream Diversion
 - AR - Access Road
 - WC - Watercourse

Son áirímh tá sonraíocht Shuirbhíreacha Orlándaí Éireann arna aistriú go dtí físeán OSI Uimh. 2010/20CCMA/Comhairle Contae na Gaillimhe. Sáráin ar aistriú go dtí na sonraíocht Shuirbhíreacha Orlándaí Éireann agus Rialtas na hÉireann. © Suirbhíreacha Orlándaí Éireann, 2010.

© Suirbhíreacha Orlándaí Éireann. Gach ceart ar chosaint. Uimhir cheadainis 2010/20CCMA/Comhairle Contae na Gaillimhe.

Includes Ordnance Survey Ireland data reproduced under OSI Licence number 2010/20CCMA/Galway County Council. Unauthorised reproduction infringes Ordnance Survey Ireland and Government of Ireland copyright. © Ordnance Survey Ireland, 2010.

© Ordnance Survey Ireland. All rights reserved. Licence number 2010/20CCMA/Galway County Council.

Clients

An Roinn Iompair Turasoireachta agus Spóirt
Department Transport, Tourism and Sport

Project Ireland 2040
The National Development Plan

Galway City Transport Project

Comhairle Chontae na Gaillimhe
Galway County Council

TII
Transport Infrastructure Institute

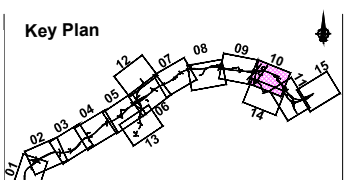

Consultant

ARUP

Corporate House
City East Business Park
Ballybrit, Galway, Ireland.

Tel +353 (0)91 460675
www.N6GalwayCity.ie
www.arup.ie

Job Title
N6 Galway City Ring Road

Scale
1:5000 @ A3

Date:
September 2018

Issue	Date	By	Chkd	Appd
I2	17/02/2020	KJ	HK	EMC
I1	28/09/2018	KJ	MH	EMC

Drawing Title
Proposed Road Development Plan
CH.13+800 to CH.15+500
Sheet 10 of 15

Drawing Status
For Information

Job No
233985

Drawing No
Figure 5.1.10

Issue
12

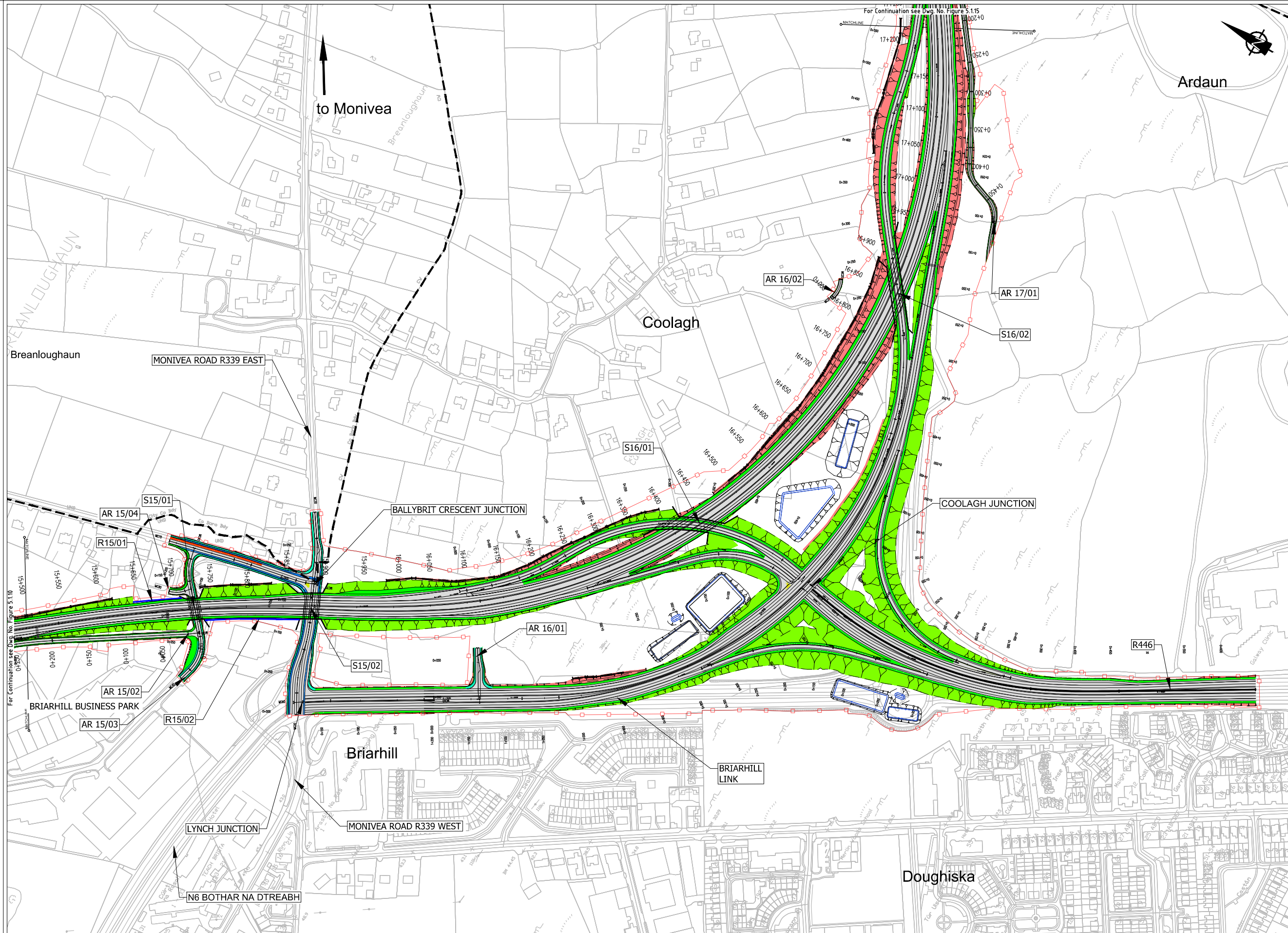

- EIA REPORT**
- Legend:**
- City Boundary
 - Proposed Development Boundary
 - Proposed Road Geometry
 - Earthworks - Fill
 - Earthworks - Cut
 - Proposed Carriageway Pavement
 - Proposed Grass Verge
 - Proposed Cycleway
 - Proposed Footpath
 - Proposed Shared Footpath/Cycleway
 - Proposed Traffic Island
 - Structure (S)
 - Proposed Retaining wall (R)
 - Proposed Mammal Underpass (C)
 - Proposed Culvert (C)
 - Proposed Attenuation Pond / Infiltration Basin / Wetlands
 - Proposed Stream Diversion
 - AR - Access Road
 - WC - Watercourse

Son áiríomh tá sonraíocht Shuirbhíreacht Orlándaís Éireann arna aistriú go dtailíú físe Chéadainn OSI Uimh. 2010/20CCMA/Comhairle Contae na Gaillimhe. Sáráilom aistriú go dtailíú físe còigeacht Shuirbhíreacht Orlándaís Éireann agus Rialtas na hÉireann. © Suirbhíreacht Orlándaís Éireann, 2010.

© Suirbhíreacht Orlándaís Éireann. Gach ceart ar chosaint. Uimhir cheadainn 2010/20CCMA/Comhairle Contae na Gaillimhe.

Includes Ordnance Survey Ireland data reproduced under OSI Licence number 2010/20CCMA/Galway County Council. Unauthorised reproduction infringes Ordnance Survey Ireland and Government of Ireland copyright. © Ordnance Survey Ireland, 2010.

© Ordnance Survey Ireland. All rights reserved. Licence number 2010/20CCMA/Galway County Council.

Clients

An Roinn Iompair Turasoireachta agus Spóirt
Department Transport, Tourism and Sport

Project Ireland 2040
The National Development Plan

Galway City Transport Project

Comhairle Chontae na Gaillimhe
Galway County Council

TIU
Transport Infrastructure Unit

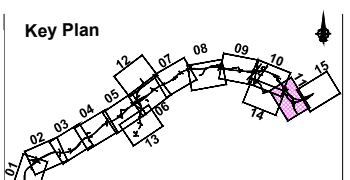

Consultant

ARUP

Corporate House
City East Business Park
Ballybrit, Galway, Ireland.

Tel +353 (0)91 460675
www.N6GalwayCity.ie
www.arup.ie

Job Title
N6 Galway City Ring Road

Scale
1:5000 @ A3

Date:
September 2018

Issue	Date	By	Chkd	Appd
I2	17/02/2020	KJ	HK	EMC
I1	28/09/2018	KJ	MH	EMC

Drawing Title
Proposed Road Development Plan
CH.15+500 to CH.17+200
Sheet 11 of 15

Drawing Status
For Information

Job No
233985

Drawing No
Figure 5.1.11

Issue
I2

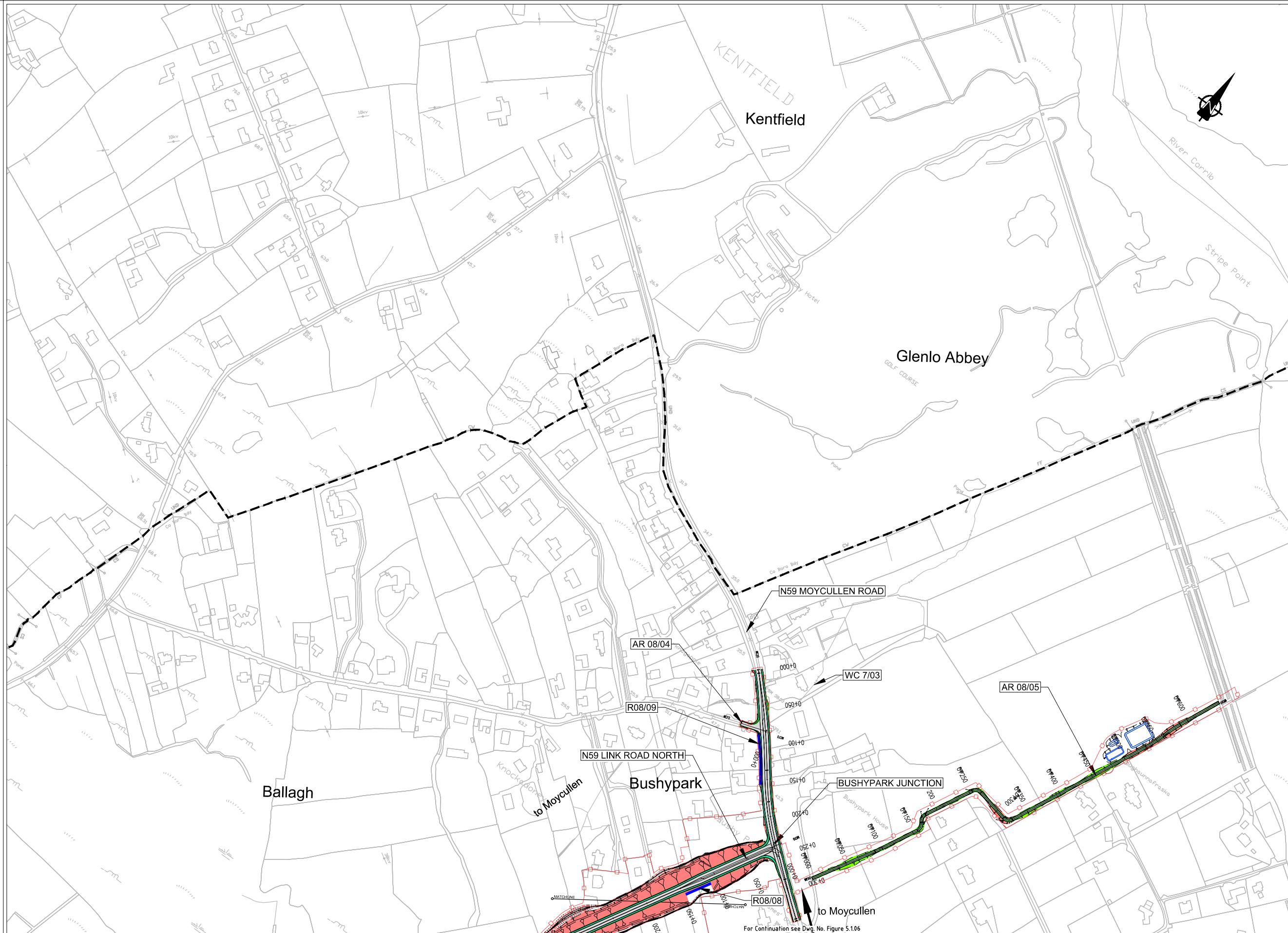

- Legend:**
- City Boundary
 - Proposed Development Boundary
 - Proposed Road Geometry
 - Earthworks - Fill
 - Earthworks - Cut
 - Proposed Carriageway Pavement
 - Proposed Grass Verge
 - Proposed Cycleway
 - Proposed Footpath
 - Proposed Shared Footpath/Cycleway
 - Proposed Traffic Island
 - Structure (S)
 - Proposed Retaining wall (R)
 - Proposed Mammal Underpass (C)
 - Proposed Culvert (C)
 - Proposed Attenuation Pond / Infiltration Basin / Wetlands
 - Proposed Stream Diversion
 - AR - Access Road
 - WC - Watercourse

Son áiríamh tá sonraíocht Shuirbhíreacht Orlánáis Éireann arna aistriú go dtí fíor Chéadánas OSI Uimh. 2010/20CCMA/Comhairle Contae na Gaillimhe. Sáráilom aistriú go dtí neamhdáraithe cóipeacht Shuirbhíreacht Orlánáis Éireann agus Rialtas na hÉireann. © Suirbhíreacht Orlánáis Éireann, 2010.

© Suirbhíreacht Orlánáis Éireann. Gach ceart ar chosaint. Uimhir cheadnáis 2010/20CCMA/Comhairle Contae na Gaillimhe.

Includes Ordnance Survey Ireland data reproduced under OSI Licence number 2010/20CCMA/Galway County Council. Unauthorised reproduction infringes Ordnance Survey Ireland and Government of Ireland copyright. © Ordnance Survey Ireland, 2010.

© Ordnance Survey Ireland. All rights reserved. Licence number 2010/20CCMA/Galway County Council.

Clients

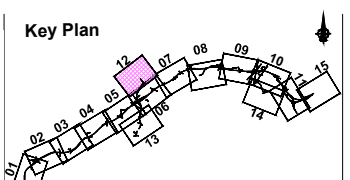

Consultant

Corporate House
City East Business Park
Ballybrit, Galway, Ireland.

Tel +353 (0)91 460675
www.N6GalwayCity.ie
www.arup.ie

Job Title
N6 Galway City Ring Road

Scale
1:5000 @ A3

Date:
September 2018

Issue	Date	By	Chkd	Appd
I2	17/02/2020	KJ	HK	EMC
I1	28/09/2018	KJ	MH	EMC

Drawing Title
**Proposed Road Development Plan
N59 Link Road North
Sheet 12 of 15**

Drawing Status
For Information

Job No 233985	Drawing No Figure 5.1.12	Issue 12
-------------------------	------------------------------------	--------------------

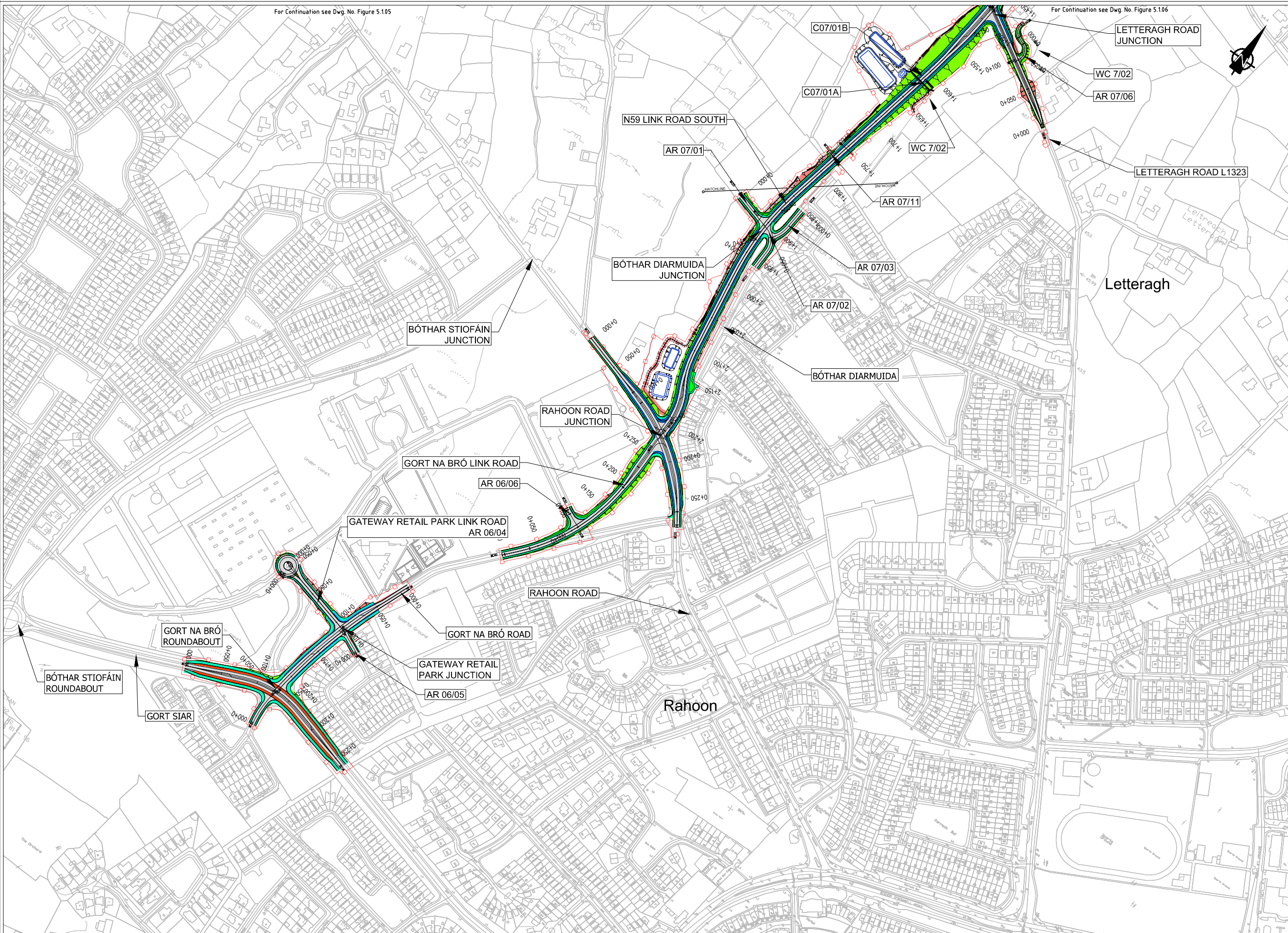

- Legend:**
- City Boundary
 - - - Proposed Development Boundary
 - ▬▬▬ Proposed Road Geometry
 - ▬▬▬ Earthworks - Fill
 - ▬▬▬ Earthworks - Cut
 - ▬▬▬ Proposed Carriageway Pavement
 - ▬▬▬ Proposed Grass Verge
 - ▬▬▬ Proposed Cycleway
 - ▬▬▬ Proposed Footpath
 - ▬▬▬ Proposed Shared Footpath/Cycleway
 - ▬▬▬ Proposed Traffic Island
 - ▬▬▬ Structure (S)
 - ▬▬▬ Proposed Retaining wall (R)
 - ▬▬▬ Proposed Mammal Underpass (C)
 - ▬▬▬ Proposed Culvert (C)
 - ▬▬▬ Proposed Attenuation Pond / Infiltration Basin / Wetlands
 - ▬▬▬ Proposed Stream Diversion
 - AR AR - Access Road
 - WC WC - Watercourse

Son áiríamh tá sonraíocht Shairbhéiríochta Ordnáis Éireann arna aistriú go dtí físeán Ceadaíonn OSI Uimh. 2010/20CCMA/Comhairle Contae na Gaillimhe. Sárúilonn aistriú go dtí neamh-darairthe cóipeacht Shairbhéiríochta Ordnáis Éireann agus Rialtas na hÉireann. © Sairbhéiríochta Ordnáis Éireann, 2010.

© Sairbhéiríochta Ordnáis Éireann. Gach ceart ar chosaint. Uimhir cheadainis 2010/20CCMA/Comhairle Contae na Gaillimhe.

Includes Ordnance Survey Ireland data reproduced under OSI Licence number 2010/20CCMA/Galway County Council. Unauthorised reproduction infringes Ordnance Survey Ireland and Government of Ireland copyright. © Ordnance Survey Ireland, 2010.

© Ordnance Survey Ireland. All rights reserved. Licence number 2010/20CCMA/Galway County Council.

Clients

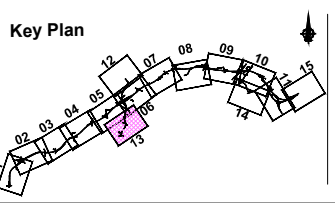

Consultant

Corporate House
City East Business Park
Ballybrit, Galway, Ireland.

Tel +353 (0)91 460675
www.N6GalwayCity.ie
www.arup.ie

Job Title
N6 Galway City Ring Road

Scale
1:5000 @ A3

Date:
September 2018

Issue	Date	By	Chkd	Appd
I2	17/02/2020	KJ	HK	EMC
I1	28/09/2018	KJ	MH	EMC

Drawing Title
Proposed Road Development Plan
N59 Link Road South, Gateway Retail Park Junction
Sheet 13 of 15

Drawing Status
For Information

Job No
233985

Drawing No
Figure 5.1.13

Issue
I2

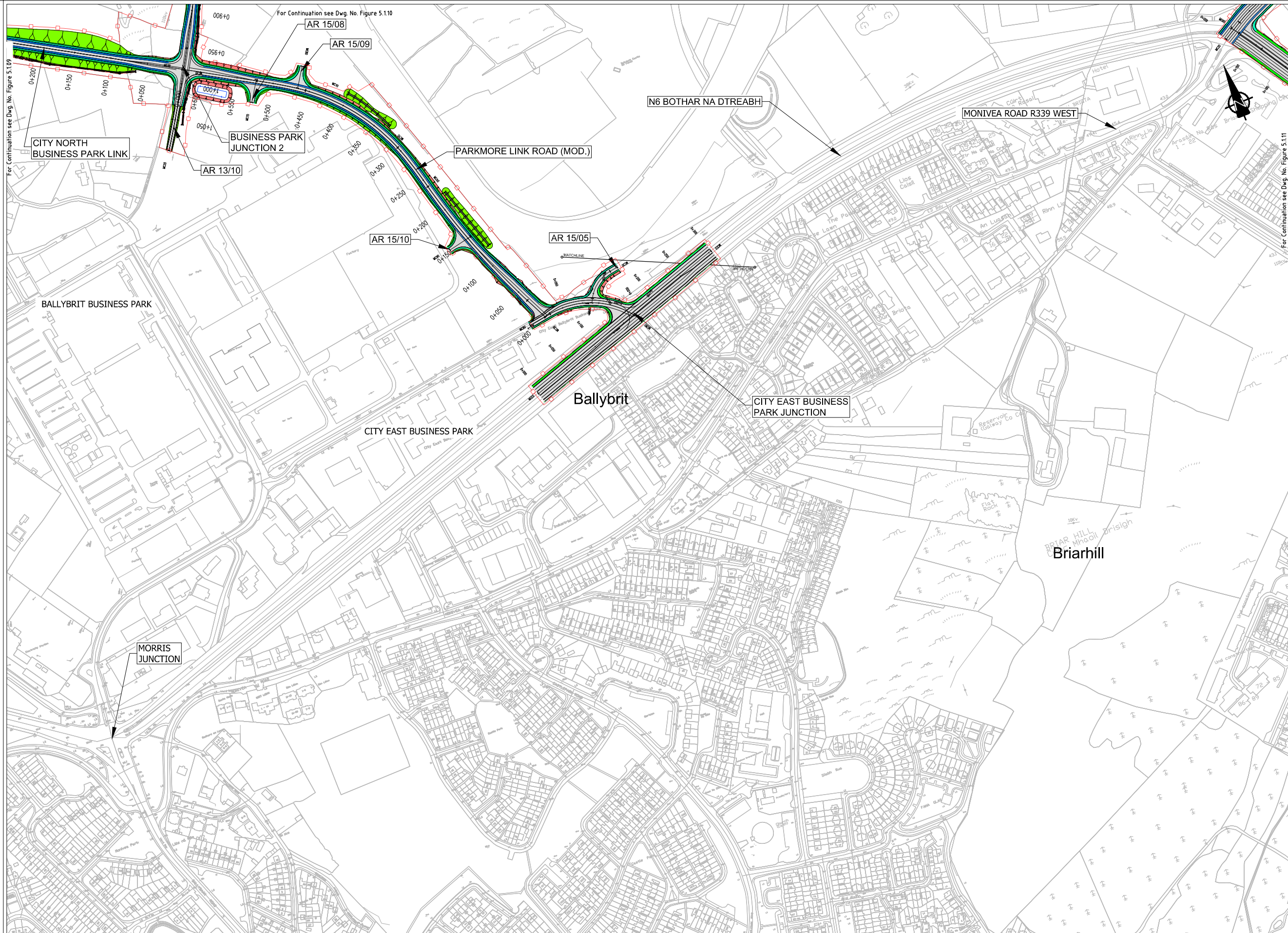

EIA REPORT

- Legend:**
- City Boundary
 - - - Proposed Development Boundary
 - ▬▬▬ Proposed Road Geometry
 - ▬▬▬ Earthworks - Fill
 - ▬▬▬ Earthworks - Cut
 - ▬▬▬ Proposed Carriageway Pavement
 - ▬▬▬ Proposed Grass Verge
 - ▬▬▬ Proposed Cycleway
 - ▬▬▬ Proposed Footpath
 - ▬▬▬ Proposed Shared Footpath/Cycleway
 - ▬▬▬ Proposed Traffic Island
 - ▬▬▬ Structure (S)
 - ▬▬▬ Proposed Retaining wall (R)
 - ▬▬▬ Proposed Mammal Underpass (C)
 - ▬▬▬ Proposed Culvert (C)
 - ▬▬▬ Proposed Attenuation Pond / Infiltration Basin / Wetlands
 - ▬▬▬ Proposed Stream Diversion
 - AR AR - Access Road
 - WC WC - Watercourse

Son áiríamh tá sonraíocht Shairbhéiríochta Orlánáis Éireann arna aistriú go dtailíocht físeánúil ón Ombú. 2010/20CCMA/Comhairle Contae na Gaillimhe. Sáráilíon aistriú go dtailíocht na cíoscheart Shairbhéiríochta Orlánáis Éireann agus Rialtas na hÉireann. © Sairbhéiríochta Orlánáis Éireann, 2010.

© Sairbhéiríochta Orlánáis Éireann. Gach ceart ar chosaint. Umhír cheadúnais 2010/20CCMA/Comhairle Contae na Gaillimhe.

Includes Ordnance Survey Ireland data reproduced under OSI Licence number 2010/20CCMA/Galway County Council. Unauthorised reproduction infringes Ordnance Survey Ireland and Government of Ireland copyright. © Ordnance Survey Ireland, 2010.

© Ordnance Survey Ireland. All rights reserved. Licence number 2010/20CCMA/Galway County Council.

Clients

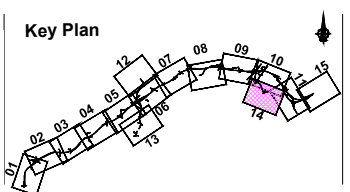

Consultant

Corporate House
City East Business Park
Ballybrit, Galway, Ireland.

Tel +353 (0)91 460675
www.N6GalwayCity.ie
www.arup.ie

Job Title
N6 Galway City Ring Road

Scale
1:5000 @ A3

Date:
September 2018

Issue	Date	By	Chkd	Appd
I2	17/02/2020	KJ	HK	EMC
I1	28/09/2018	KJ	MH	EMC

Drawing Title
**Proposed Road Development Plan
City East Junction
Sheet 14 of 15**

Drawing Status
For Information

Job No
233985

Drawing No
Figure 5.1.14

Issue
I2

- Legend:**
- City Boundary
 - Proposed Development Boundary
 - Proposed Road Geometry
 - Earthworks - Fill
 - Earthworks - Cut
 - Proposed Carriageway Pavement
 - Proposed Grass Verge
 - Proposed Cycleway
 - Proposed Footpath
 - Proposed Shared Footpath/Cycleway
 - Proposed Traffic Island
 - Structure (S)
 - Proposed Retaining wall (R)
 - Proposed Mammal Underpass (C)
 - Proposed Culvert (C)
 - Proposed Attenuation Pond / Infiltration Basin / Wetlands
 - Proposed Stream Diversion
 - AR - Access Road
 - WC - Watercourse

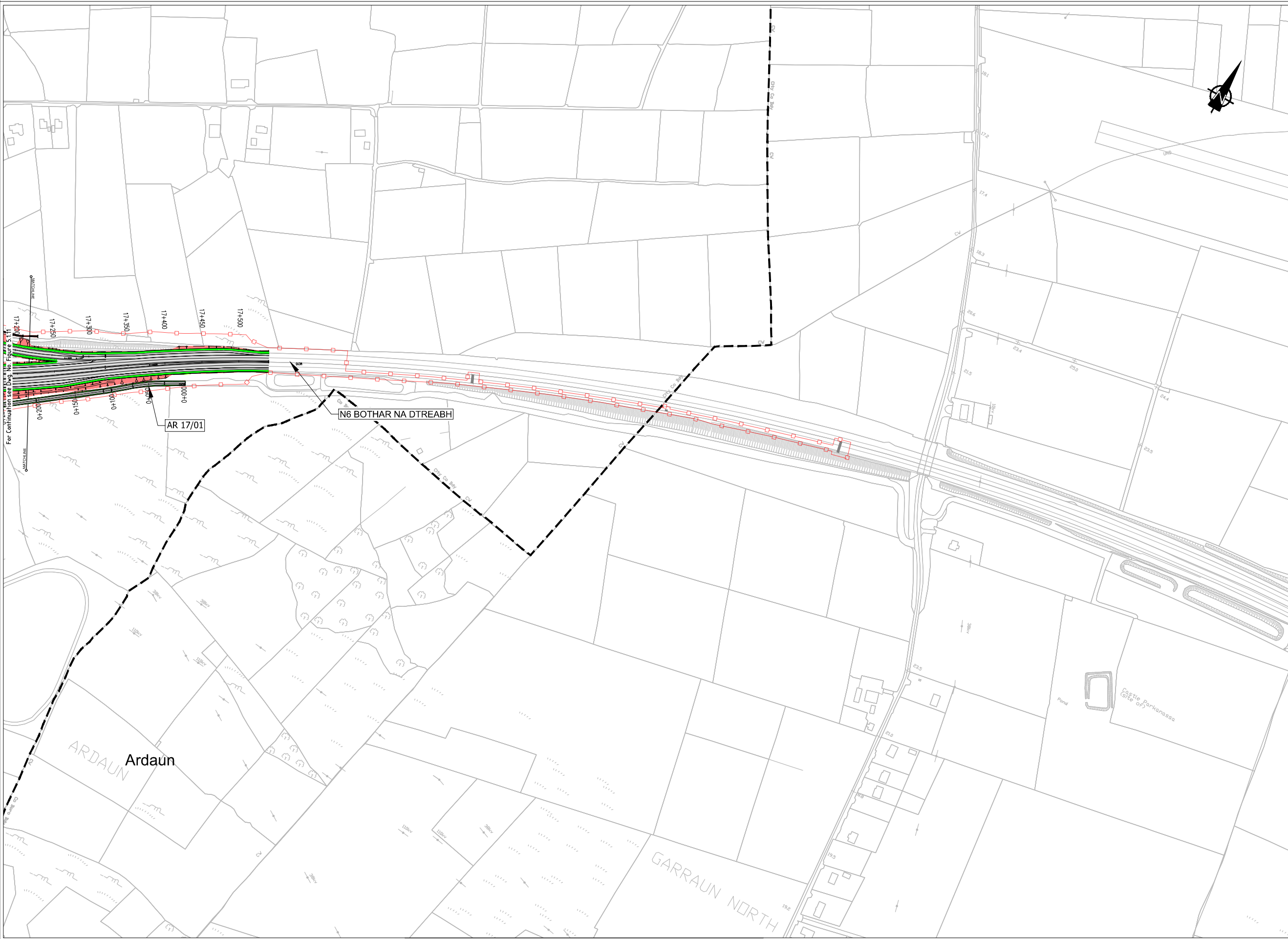

Sun áiríamh tá sonraíocht Shuirbhíreacht Orláinís Éireann arna áirígeadh fíor Cheadúnas OSI Uimh. 2010/20CCMA/Comhairle Contae na Gaillimhe. Sáráilom áirígeadh neamhdáraithe cóipeacht Shuirbhíreacht Orláinís Éireann agus Rialtas na hÉireann. © Suirbhíreacht Orláinís Éireann, 2010.

© Suirbhíreacht Orláinís Éireann. Gach ceart ar chosaint. Uimhir cheadúnais 2010/20CCMA/Comhairle Contae na Gaillimhe.

Includes Ordnance Survey Ireland data reproduced under OSI Licence number 2010/20CCMA/Galway County Council. Unauthorised reproduction infringes Ordnance Survey Ireland and Government of Ireland copyright. © Ordnance Survey Ireland, 2010.

© Ordnance Survey Ireland. All rights reserved. Licence number 2010/20CCMA/Galway County Council.

Clients

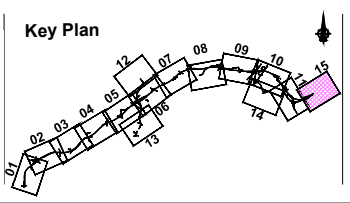

Consultant

Corporate House
City East Business Park
Ballybrit, Galway, Ireland.

Tel +353 (0)91 460675
www.N6GalwayCity.ie
www.arup.ie

Job Title
N6 Galway City Ring Road

Scale
1:5000 @ A3

Date:
September 2018

Issue	Date	By	Chkd	Appd
I2	17/02/2020	KJ	HK	EMC
I1	28/09/2018	KJ	MH	EMC

Drawing Title
Proposed Road Development Plan
CH.17+200 to (End of Scheme-Existing N6-CH.18+550)
Sheet 15 of 15

Drawing Status
For Information

Job No 233985	Drawing No Figure 5.1.15	Issue 12
-------------------------	------------------------------------	--------------------